



WIRE ROPE

CARPENTER WIRE ROPE STOPPERS

MODEL NO.	STEEL WIRE ROPE DIAMETER (MM)	SWL (TONS)	DIMENSIONS (MM)						MASS (KGS.)
			A	B	C	D	E	F	
RS-20	14 - 20	5	158	70	95	136	24	20	6
RS-28	22 - 28	10	218	95	133	191	33	27	16
RS-36	30 - 36	17	280	127	170	244	43	35	34
RS-44	38 - 44	25	342	156	208	298	53	43	63
RS-52	48 - 52	35	405	184	247	355	58	52	103
RS-56	54 - 56	40	436	198	266	382	66	56	129
RS-64	60 - 64	55	498	227	304	437	75	64	193
RS-76	72 - 76	75	592	268	361	518	90	76	324
RS-84	78 - 84	90	610	276	376	540	90	76	360
RS-90	86 - 90	105	630	288	392	572	96	86	395

Remark: 1. Proof Load = 2 x SWL
 2. Breaking Load = 5 x SWL
 3. Steel Wire Rope = RHL 6 Strand

Compact design cable grip for cable diameter 14 - 90mm. Safe working load factor exceeds that of matching cable size.

Hinged body has fixed smooth groove on one side
 Movable wedge, grooved with lay of cable, on the facing side.

Movable wedge enables cable to be drawn tight. Cable can be released while under full tension by releasing latch on hinged lid. Lid is securely latched with pin while in use. Shackle holes are provided for rigging bridle to stopper. Bridles available with stopper if desired. Occasionally apply grease to ensure a long trouble free life.

Optional class approval certificate as request.

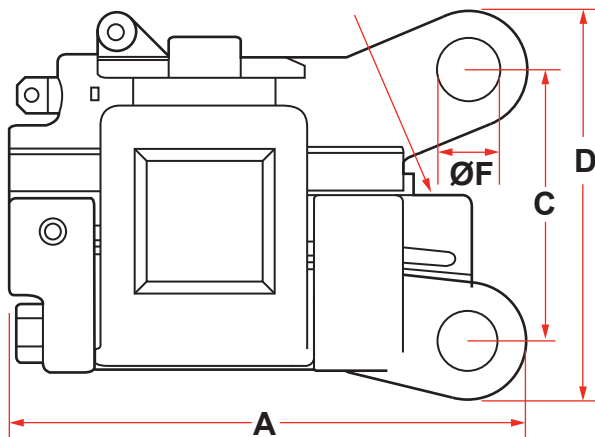
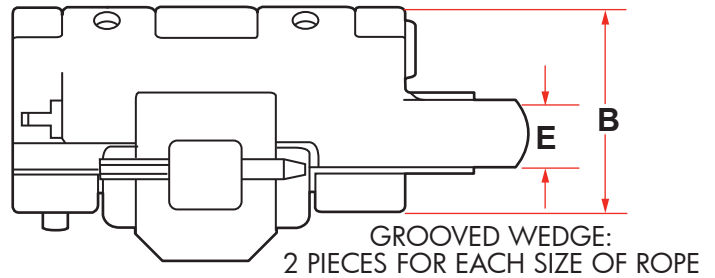

WIRE ROPE

